

DIAMANT - KERNBOHRMASCHINE TYP DKS 32
 DIAMOND - CORE DRILL TYPE DKS 32

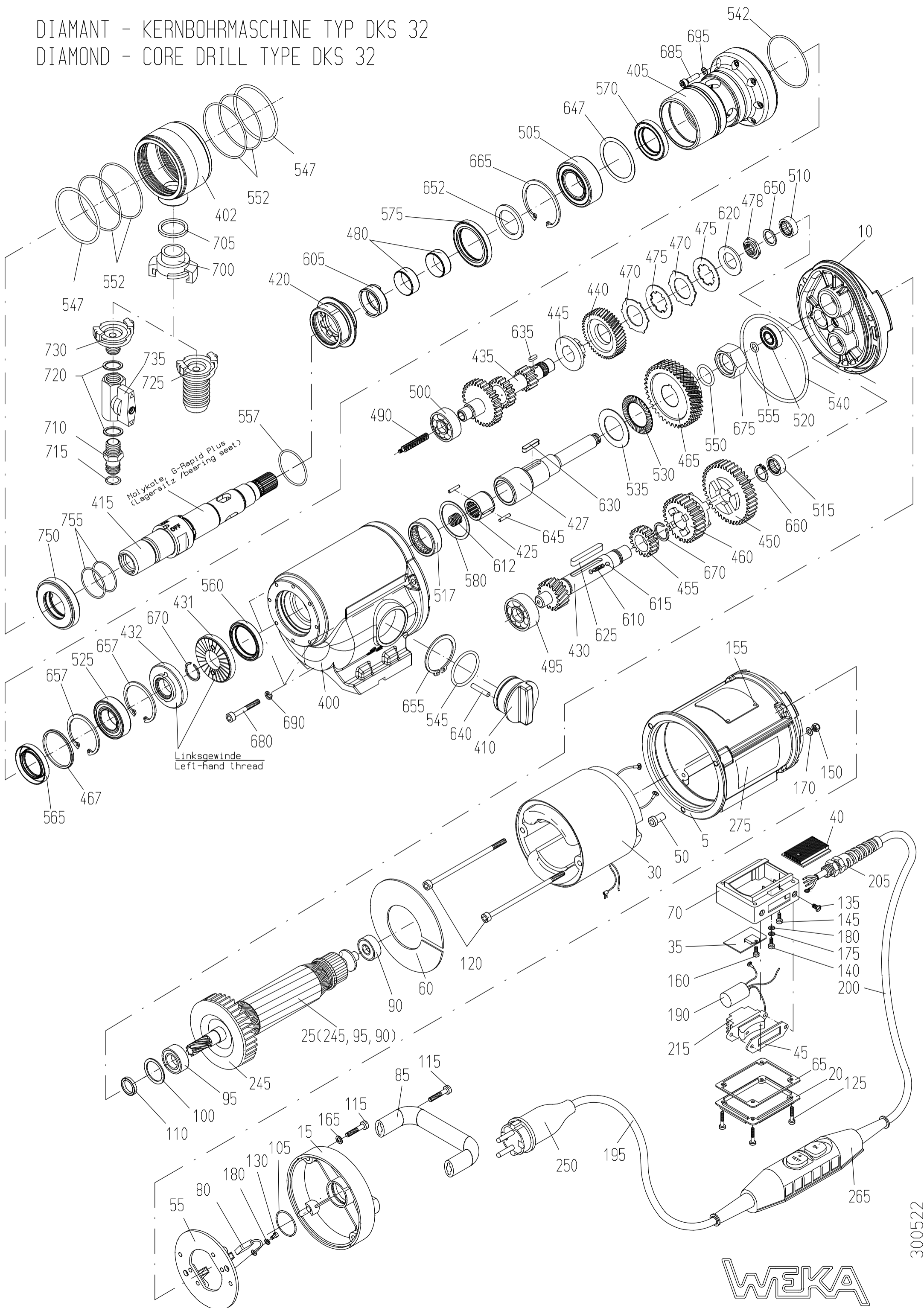

**Spare Parts Price List - Diamond Core Drill
Type DKS32 (S) - Motor**

EPE-DKS32

FIG	NO	DESCRIPTION	STANDARD	TYPE	PART NO
5	1	Motor case			DK30101
10	1	Intermediate Flange cpl. with fig. 110, 510, 515, 520, 540			DKS30102C
15	1	Motor Top Hood with O-Ring			DK30103C
20	1	Terminal Case Cover			DK20106
25	1	Armature with Fan and Bearings	230V		DK30108-1
	1	Armature with Fan and Bearings	110V		DK30108/11-1
30	1	Field compl.	230V		DK30109
	1	Field compl.	110V		DK30109/11
35	1	Electronic Module	230V		DK30510-1
	1	Electronic Module	110V		DK30510/11-1
40	1	Cooling Profile			DK30140
45	1	Switch Sealing			DK20121
50	2	Field Screw Insulating Sleeve			DK20116
55	1	Brush Holder Disc			DK20117
60	1	Air Conducting Disc			DK20118
65	1	Terminal Case Sealing			DK40122
70	1	Terminal Case for motor electronic 230V			DK30130
	1	Terminal Case for motor electronic 110V			DK30131
80	2	Carbon Brush	230V		DK20125
	2	Carbon Brush	110V		DK20125/11
85	1	Carrying Handle			DK30105
90	1	Ball Bearing			6062012
95	1	Ball Bearing			6060021
100	1	Compensation Washer			2632201
105	1	O-Ring	RDR 32x3		5532003
110	1	Rotary Shaft Seal	RWD12x24x7		5012247
115	6	Hex. Socket Head Screw	M6x35		0106035
120	2	Hex. Socket Head Screw	M5x120		0105120
125	4	Fill. Head Screw	M4x40		0204040
130	2	Fill. Head Screw	M4x6		0204006
135	2	Slot. Count. Head Screw	M4x6		0414006
140	1	Slot. Pan Head Screw	M4x6		0304006
145	1	Pan Head Tapping Screw	C 3,9x9,5		0539295
150	2	Hexagon Nut	M5		1005000
155	4	Round Head grooved Pin	2,3x4		2223004
160	1	Hexagon Socket Head Screw	M4x6		0104006
165	4	Locking Washer	SM6		1806000
170	2	Curved Spring Washer	A5		1805137
175	1	Curved Spring Washer	A4		1804137
180	3	Medium Washer	4,3		1804433
185	1	Slot. Set Screw	M6x5		0706005
190	1	Int. Suppr. Capacitor			DK20133-1
195	1	Cord 3G1,5x1,5m	PRCD 230V		8715152
200	1	Cord 3G1,5x2,3m	PRCD 230V		8723152
	1	Cord 3G4x3,8m	110V		8738043
205	1	Cord Gland			8804020
215	1	Motor Switch			8023005
245	1	Fan			DK20105
250	1	Mains Plug (for PRCD)	Schuko		8016013
	1	Mains Plug GB	CEE 32A 4h		8032004
265	1	PRCD Inline Protector	230V		8400010C
275	1	Pointing Sticker			DK20620

Spare Parts Price List - Diamond Core Drill Type DKS32 (S) - Gear

FIG	NO	DESCRIPTION	STANDARD	TYPE	PART NO
400	1	Gear Box			DKS30201
402	1	Suction hood			DKS30250C
405	1	Bearing case			DKS30204
410	1	Gear Change Grip cpl. with fig. 545, 640			SR70203C
415	1	Drill Spindle 1 1/4" UNC with fig. 480			DKS30206C
420	1	Rotating sleeve cpl. with fig. 557			DKS30240C
425	1	Tooth sleeve			DKS30225
427	1	Drive shaft cpl. with fig. 425, 645			DKS30210C
430	1	Gear Change Shaft			DK30207
	1	Gear Change Shaft		DKS32 S	DK20207
431	1	Tooth washer gear box			DKS30235.24
432	1	Tooth washer spindle shaft			DKS30230.24
435	1	Pinion Shaft			SR30208-1
440	1	Spur Wheel			SR30209
445	1	Bearing Bush			SR30221
450	1	Gear Wheel 1			DK30212
455	1	Gear Wheel 3			DK30213
460	1	Slide Gear Wheel			DK30214
465	1	Spindle Wheel			SR30215
	1	Spindle Wheel		DKS32 S	SR30215S
467	1	Distance sleeve			DKS30245
470	2	Brake Disk			SR30218
475	2	Pressure Disk			SR30219
478	1	Hexagon Nut			SR30220-2
480	2	Shaft Wearing Sleeve			DKS30220
490	1	Feed Worm			SR30230
495	1	Ball Bearing			6063020
500	1	Ball Bearing			6062010
505	1	Angular ball Bearing			6030060
510	1	Needle Bush			6314121
515	1	Needle Bush			6314120
517	1	Needle Bush			6335120
520	1	Ball Bearing			6060012
525	1	Ball Bearing			6060052
530	1	Thrust Needle Cage			6530470
535	1	Thrust Bearing Washer			6530471
540	1	O-Ring	RDR110x3		5511003
542	1	O-Ring	RDR60x2		5560002
545	1	O-Ring	RDR36x3		5536003
547	2	O-Ring	RDR63x3		5563003
550	1	O-Ring	RDR20x3		5520003
552	4	O-Ring	RDR64x2		5564002
555	1	O-Ring	RDR8x2		5508002
557	1	O-Ring	RDR40x2		5540002
560	1	Rotary Shaft Seal	35x47x7		5035477
565	1	Rotary Shaft Seal	30x47x7AS		5030479
570	1	Rotary Shaft Seal	30x47x7		5030477
575	1	Rotary Shaft Seal	40x55x7AS		5040557
580	1	Compensations Washer	40x46,5x0,5		2646401
605	1	Pressure Spring			4320032
610	1	Pressure Spring			4305235
612	1	Pressure Spring			4320018
615	2	Ball	4		2204000
620	1	Disk Spring	31,5x16,3x2		4031162
625	1	Parallel Key	A6x6x45		3006045
630	1	Parallel Key	A5x5x25		3005025
635	1	Parallel Key	A4x4x10		3004010
640	1	Parallel Pin	5m6x25		2505025
645	2	Parallel Pin	3m6x16		2503016
647	1	Shim Ring	PS45x55x0,5		1945550
650	1	Shim Ring	PS14x20x1		1914201
652	1	Supporting ring	30x42x2,5		1830420
655	1	Retaining Ring	42x1,75		3542175
657	2	Retaining Ring	47x1,75		3447175
660	1	Retaining Ring	16x1		3516001
665	1	Retaining Ring	55x2		3455002
670	2	Retaining Ring	SW20		3620000
675	1	Hexagon Nut	M22x1,5		SR30226
680	3	Hex. Soc. Head Screw	M6x50		0106050

685	8	Hex. Soc. Head Screw	M5x20		0105023
690	3	Locking Washer	SM6		1806000
695	8	Locking Washer	SM5		1805000
700	1	Thread coupling G3/4a	G3/4a		7034501
705	1	Sealing Ring	G3/4		7034003
710	1	Quick Connect Nipple			DK20225
715	1	O-ring	RDR11x2,5		5511025
720	2	Sealing Ring	G1/4"		7014003
725	1	Hose Coupling 32mm	Ø32		7000532
	1	Hose Coupling 38mm	Ø38		7000538
730	1	Thread Coupling	G1/4"		7014500
735	1	Ball Valve	G1/4"/i		7014001
750	1	Antifriction Element			AE35
755	2	O-Ring	32x1,5		5532015
800	1	Gear oil	300ml		9030001
805	1	Gear grease Tooth washer	20gr		9900528
	1	Face pin wrench	35x5		9800355

The prices listed are gross prices in € per item, plus statutory Value added tax.

When ordering spare parts, please always state: machine number, quantity, designation, spare part number and, for electrical parts, the nominal voltage (if different from 230 V).

WEKA Elektrowerkzeuge KG, Auf der Höhe 20, D 75387 Neulach - Altbulach
 Telephon: +49 7053 96816-0, spare parts: +49 7053 96816-14 · Telefax: +49 7053 3138
 Internet: www.weka-elektrowerkzeuge.de · E-mail: weka@weka-elektrowerkzeuge.de